

Satsop Business Park Haul Road Erosion Mitigation Project

WPPA Environmental Conference

Thursday, September 21, 2023

Presentation by Kris Koski, Port Engineer



Port of Grays Harbor

On Washington's Pacific Coast



Satsop Business Park Quick Intro



- Site developed in 1970s-1980s as a nuclear power plant by WPPSS. Plant was never completed.
- Grays Harbor County acquired site in 1998 to operate as a business park.
- The Port of Grays Harbor acquired the site in 2013 and continues to operate it as a business park with commercial and industrial space.

Haul Road Erosion Background

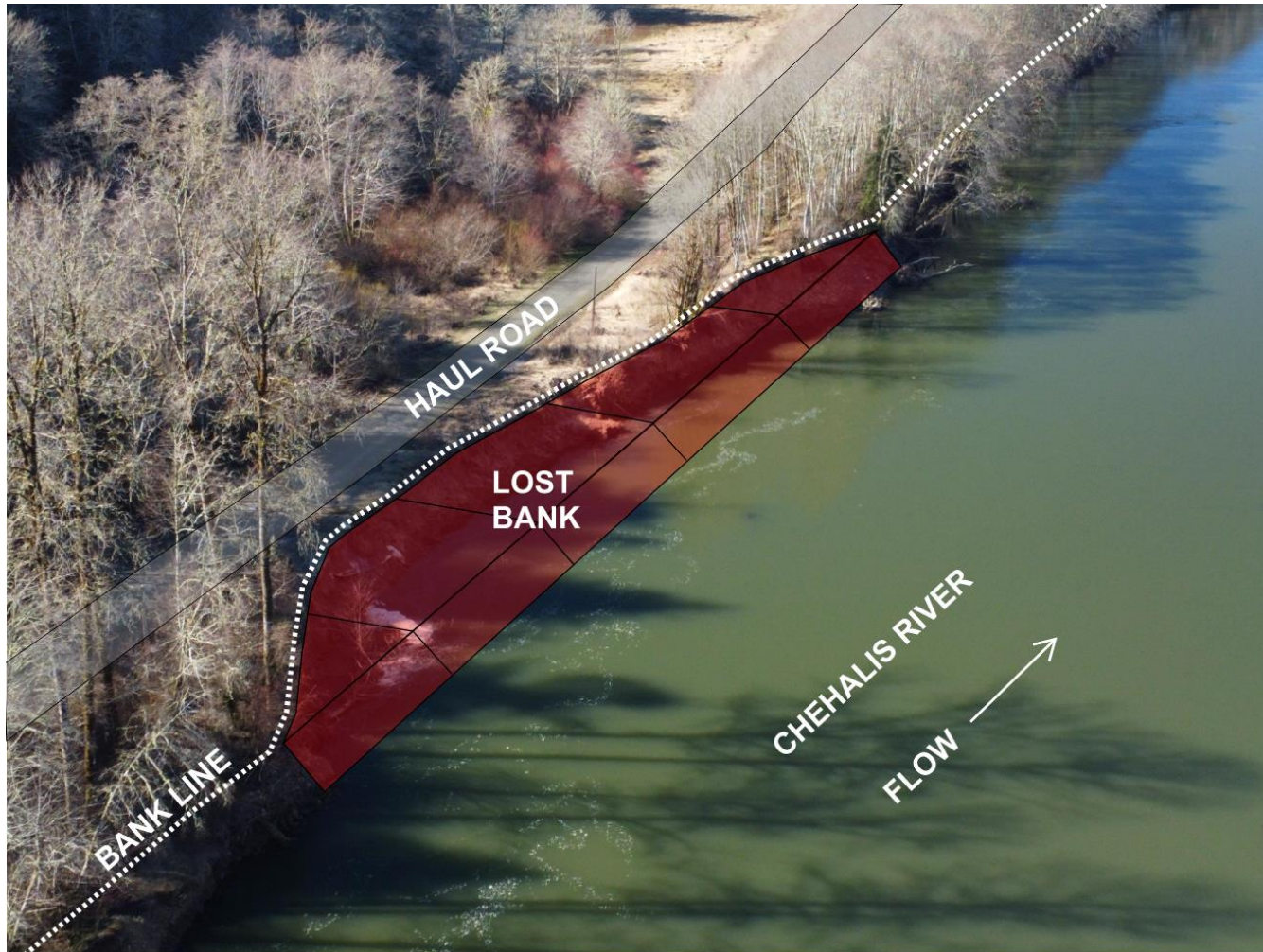

- Haul Road utility corridor built with original nuclear plant development.
- Runs approximately four miles between Ranney collector wells in Chehalis River floodplain and Satsop Business Park on nearby hill.
- Includes 42" water main supplying Satsop Business Park with industrial and backup potable water.

Haul Road Erosion Short-Term Project

- Winter 2021-2022 Accelerated Erosion
- March 2022 Began Planning for Short-Term Action
- September 2022 Construction of Short-Term Action







Haul Road Erosion Mid-Term Project

- October 2022 Began Planning
- January 2023 Agency Pre-Submittal Meetings
- February 2023 Permits Submitted
- Feb-Mar 2023 Tribal Consultation
- March 2023 HPA Issued
- March 2023 Coast Guard Vessel Safety Concurrence
- April 2023 Shorelines Hearing
- May 2023 Bid Documents Complete
- July 2023 All Remaining Permits In-Hand
- July-August 2023 In-Water Work Window, Construction Completed

Haul Road Erosion Mid-Term Project Plan

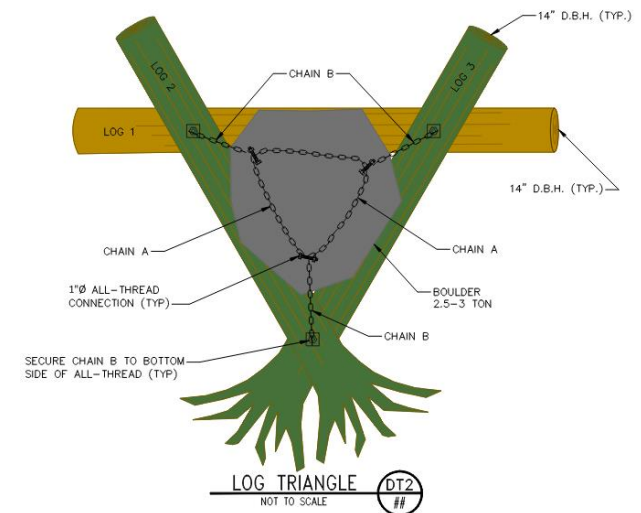
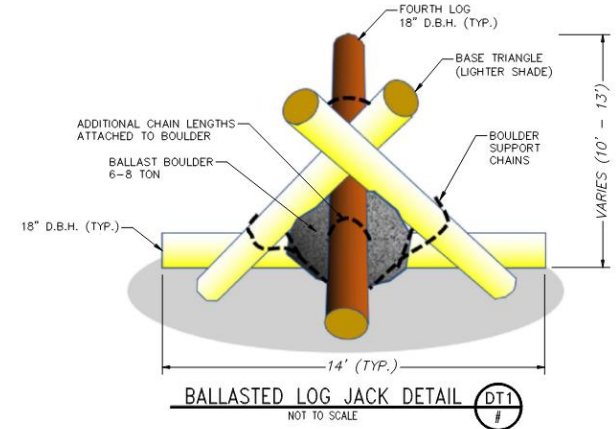
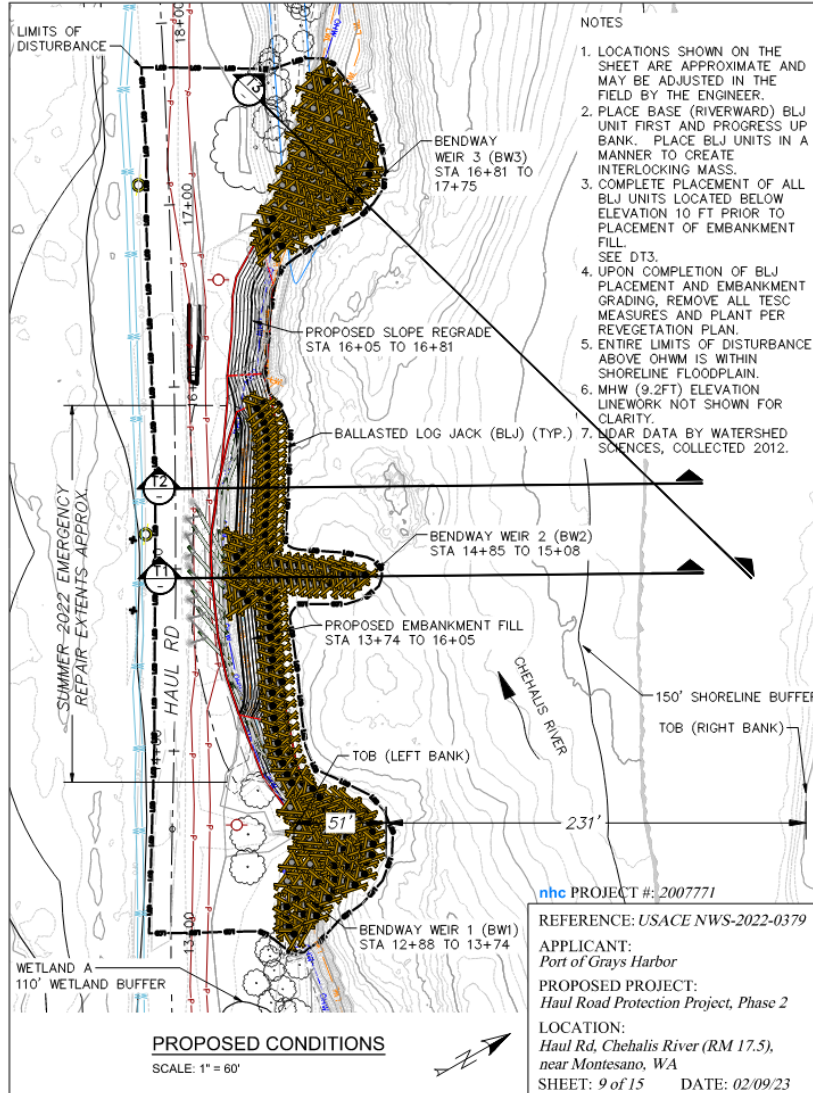
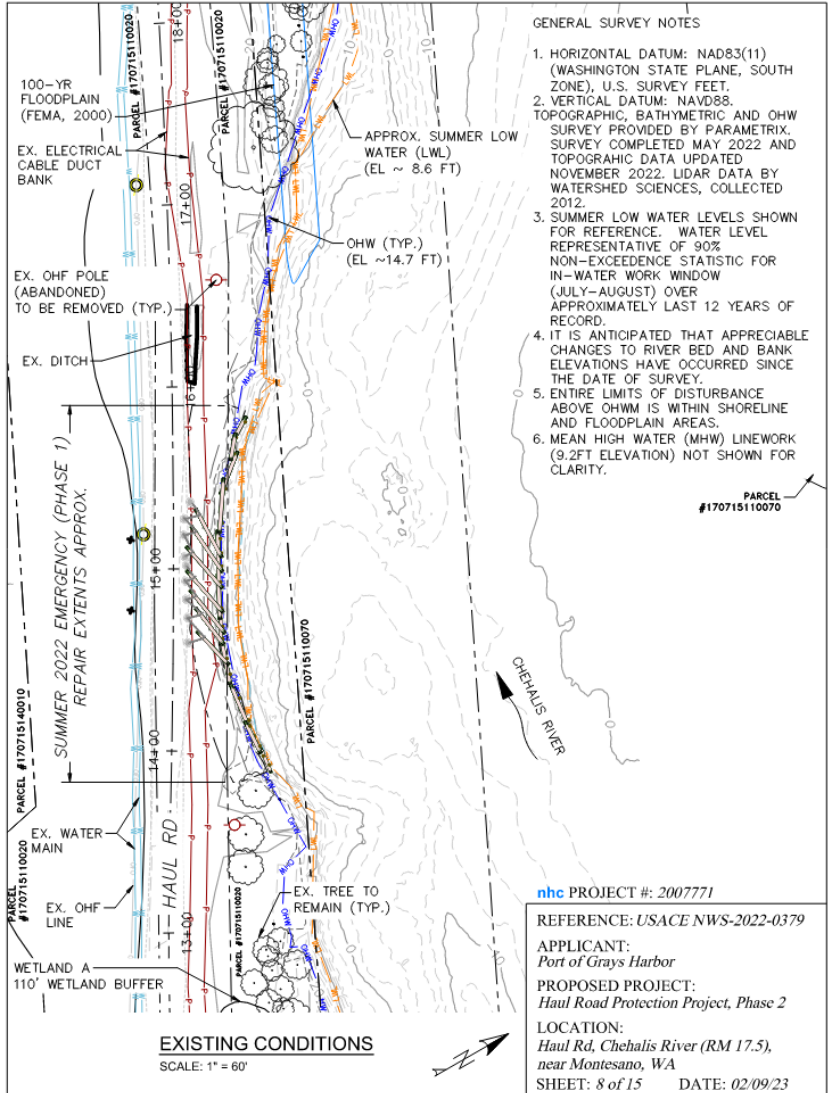





Questions / Discussion

Kris Koski, Port Engineer

kkoski@portgrays.org

360-533-9545



Port of Grays Harbor

On Washington's Pacific Coast